

# GPN 655

Free test samples:

+49 4442 982-9100  
 poeppelmann.com/en/gpn655a  
 poeppelmann.com/en/gpn655b

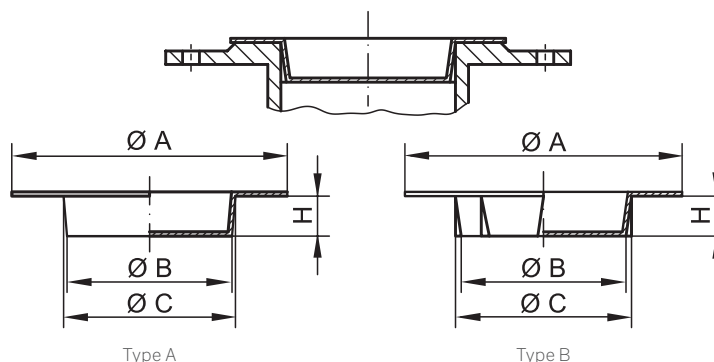

**Standard colour:** Yellow

**Material:** PE-LLD (type A), PE-LD (type B)



**Better fit.**

Protection for flanges in accordance with ANSI/ASME B 16.5.



**More versatile.**

Design B with additional clamping ribs for accommodating larger tolerances.



**Better.**

Closes the opening and protects the sealing face of the flange fitting.

**Type A** (shaft without ribs)

item	Suitable for external Nominal width	Dimensions				Order no.
		A	B	C	H	
GPN 655 / 200	200	270	208	210	18	655 0200 0000
GPN 655 / 250	250	375	255	261	20.5	655 0250 0000
GPN 655 / 300	300	375	308	313	22	655 0300 0000
GPN 655 / 350	350	440	341	346	22.5	655 0350 0000
GPN 655 / 400	400	490	398	408	30	655 0400 0000

**Type B** (shaft with ribs)

item	Suitable for external Nominal width	Dimensions				Order no.
		A	B	C	H	
GPN 655 / 15-R	15	75	16.7	17.8	10	655 0015 0000
GPN 655 / 25-R	25	100	27.3	28.8	15	655 0025 0000
GPN 655 / 32-R	32	110	36.5	38.5	15	655 0032 0000
GPN 655 / 40-R	40	125	42	44.4	15	655 0040 0000
GPN 655 / 50-R	50	135	55	56.5	15	655 0050 0000
GPN 655 / 65-R	65	122	68	71	20	655 0065 0000
GPN 655 / 80-R	80	138	81	83.1	20	655 0080 0000
GPN 655 / 100-R	100	190	106	108.5	20	655 0100 0000
GPN 655 / 125-R	125	225	131.5	134	20	655 0125 0000
GPN 655 / 150-R	150	270	160	161.5	20	655 0150 0000

Size in mm

For information regarding materials, colours, drawings and the use of our items, please refer to pages 124/125.

You might also be interested in the following products: GPN 650, GPN 670, GPN 680