

# Universal Protection with Ring Lug

## GPN 615

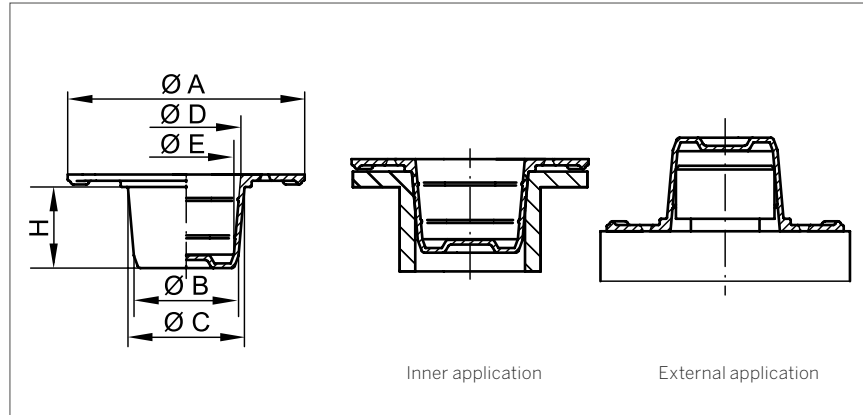

Dimensions							Order no.
A	Inner application			External application		Order no.	
	B	C	H	D	E		
29.0	7.6	9.1	10.0	7.7	6.2	615 UL 88	
29.0	7.8	9.5	10.0	8.0	6.3	615 UL 91	
29.0	9.5	11.1	10.0	9.6	7.9	615 UL 107	
29.0	10.2	11.9	10.0	10.3	8.6	615 UL 114	
29.0	11.5	13.1	10.0	11.6	9.9	615 UL 127	
32.0	13.1	15.0	12.0	13.6	11.6	615 UL 147	
34.0	13.5	15.2	12.0	14.1	12.1	615 UL 152	
34.0	14.9	17.0	13.0	15.6	13.4	615 UL 167	
38.0	17.0	19.2	13.0	17.5	15.3	615 UL 187	
40.0	18.6	21.1	15.0	19.5	16.9	615 UL 207	
46.0	21.5	24.7	18.0	22.9	19.8	615 UL 241	
56.0	28.1	30.6	19.0	29.7	26.4	615 UL 309	
80.0	42.2	45.4	19.0	43.5	40.2	615 UL 448	
95.0	58.4	62.8	25.0	60.8	56.4	615 UL 628	

Size in mm

### Your KAPSTO® quality benefits:



**Time-saving:** Easy removal due to ring lug.



**Multifunctional:** The tapered design of the plug accommodates larger tolerances. Can also be used as a cap.



**Technical cleanliness:** Production in accordance with VDA Band 19 and ISO 16232 in our specially equipped cleanroom on request. For more information, please see page 116/117.



**Additional information:** Protects threads, pipes, hoses and bores. No loss of construction space due to flat-type ring lug.

**Material:** PE-LD

**Color:** Yellow

Color and material alternatives, additional sizes, bespoke designs and technical cleanliness on request. For more information about materials, colors, drawings and application of our items, please see page 114/115.

### Application Guide

Suitable for use as plug (Inner application)				
Metric threads			Pipe thread	Order no.
Fine thread				
M 10 x 1	M 10 x 1.5		G 1/8	615 UL 88
	M 12 x 1.5			615 UL 91
				615 UL 107
	M 14 x 1.5		G 1/4	615 UL 114
				615 UL 127
	M 16 x 1.5		G 3/8	615 UL 147
				615 UL 152
M 18 x 1.5		G 1/2	615 UL 167	
			615 UL 187	
			615 UL 207	
M 20 x 1.5		G 5/8	615 UL 241	
			615 UL 207	
M 22 x 1.5		G 3/4	615 UL 241	
			615 UL 241	
M 26 x 1.5		G 1	615 UL 309	
			615 UL 309	
M 32 x 1.5	M 32 x 2	G 1 1/2	615 UL 448	
			615 UL 448	

This application table is a guide only. We will be happy to send you free samples for testing. For apertures and bore holes without thread, please use dimensions B and C.

>> You also might be interested in the following products:  
GPN 305, GPN 308, GPN 610, GPN 620



**PÖPPELMANN**

We will be happy to advise you: +1 828-466-9519

**KAPSTO®**