

Protective Caps - GPN 690

100% Post-Consumer Recyclate



www.blauer-engel.de/uz30a

Material: PCR-PE

Standard colour: recycling blue

Functional dimensions:

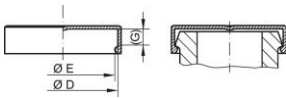

Dimension	NW mm	NW inch	D	E	G	Article number
GPN 690 / 3001 PCR-PE recycling blue	12	1/2	30,2	29,4	6,9	690 3001 RB61
GPN 690 / 6001 PCR-PE recycling blue	12	1/2	31,7	30,9	7,9	690 6001 RB61
GPN 690 / 3002 PCR-PE recycling blue	20	3/4	38,1	37,3	6,9	690 3002 RB61
GPN 690 / 6002 PCR-PE recycling blue	20	3/4	41,3	40,5	8,9	690 6002 RB61
GPN 690 / 3003 PCR-PE recycling blue	25	1	44,4	43,6	8,1	690 3003 RB61
GPN 690 / 6003 PCR-PE recycling blue	25	1	47,4	46,4	9,5	690 6003 RB61
GPN 690 / 3004 PCR-PE recycling blue	32	1 1/4	50,8	50	8,1	690 3004 RB61
GPN 690 / 6004 PCR-PE recycling blue	32	1 1/4	54	53,2	10,4	690 6004 RB61
GPN 690 / 3005 PCR-PE recycling blue	40	1 1/2	60,3	59,5	8,1	690 3005 RB61
GPN 690 / 6005 PCR-PE recycling blue	40	1 1/2	63,5	62,5	12,7	690 6005 RB61
GPN 690 / 3006 PCR-PE recycling blue	50	2	71,4	70,6	9,7	690 3006 RB61

Dimensions in mm. Information on materials, colours, drawings and use of our articles can be found on pages 166/167. This application table represents guideline values. We would be pleased to send you free samples. The versions shown opposite have been specially developed to cover SAE flanges. Pressure ratings: 3000 PSI and 6000 PSI.

For these articles, colour deviations and black dots that cannot be completely avoided in production are permissible. We recommend carrying out functional tests before series production. *The article consists of 98 % PCR-PE (Post Consumer Recyclate) and 2 % colour based on a PIR carrier (Post Industrial Recyclate).

Our product advantages at a glance:



Passender.
Zum Schutz von SAE-
Flanschbunden.



Besser.
Auch für Rohrenden und Schlauchanschlüsse geeignet.
Umlaufende Wulst sorgt für einen festen Sitz bei
einfacher Handhabung.



Ressourcenschonender.
Der eingesetzte Kunststoff
besteht aus 100 % Rezyklat

The following products might also interest you:



GPN 640