

Protective Caps - GPN 690

Virgin material



Material: PE-LD - Material: PE-LLD

Standard colour: yellow

Functional dimensions:

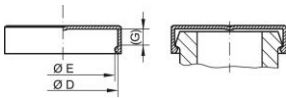

Dimension	NW mm	NW inch	D	E	G	Article number
GPN 690 / 3001 LDPE sulphur yellow	12	1/2	30,2	29,4	6,9	690 3001 0000
GPN 690 / 6001 LDPE sulphur yellow	12	1/2	31,7	30,9	7,9	690 6001 0000
GPN 690 / 3002 LDPE sulphur yellow	20	3/4	38,1	37,3	6,9	690 3002 0000
GPN 690 / 6002 LDPE sulphur yellow	20	3/4	41,3	40,5	8,9	690 6002 0000
GPN 690 / 3003 LDPE sulphur yellow	25	1	44,4	43,6	8,1	690 3003 0000
GPN 690 / 6003 LDPE sulphur yellow	25	1	47,4	46,4	9,5	690 6003 0000
GPN 690 / 3004 LDPE sulphur yellow	32	1 1/4	50,8	50	8,1	690 3004 0000
GPN 690 / 6004 LDPE sulphur yellow	32	1 1/4	54	53,2	10,4	690 6004 0000
GPN 690 / 3005 LDPE sulphur yellow	40	1 1/2	60,3	59,5	8,1	690 3005 0000
GPN 690 / 6005 LDPE sulphur yellow	40	1 1/2	63,5	62,5	12,7	690 6005 0000
GPN 690 / 3006 LDPE sulphur yellow	50	2	71,4	70,6	9,7	690 3006 0000
GPN 690 / 6006 LLDPE sulphur yellow	50	2	79,4	78,6	12,7	690 6006 0000
GPN 690 / 0090 LLDPE sulphur yellow			90,3	88,3	9	690 0090 0000
GPN 690 / 0106 LLDPE sulphur yellow			106	104	10	690 0106 0000
GPN 690 / 0125 LLDPE sulphur yellow			125	123	11	690 0125 0000
GPN 690 / 0150 LLDPE sulphur yellow			150	148	12	690 0150 0000
GPN 690 / 0213 LLDPE sulphur yellow			213	211	16	690 0213 0000

Dimensions in mm. Information on materials, colours, drawings and use of our articles can be found on pages 166/167. This application table represents guideline values. We would be pleased to send you free samples. The versions shown opposite have been specially developed to cover SAE flanges. Pressure ratings: 3000 PSI and 6000 PSI.

Our product advantages at a glance:



Passender.
Zum Schutz von SAE-
Flanschbunden.



Besser.
Auch für Rohrenden und Schlauchanschlüsse geeignet. Umlaufende Wulst sorgt für einen festen Sitz bei einfacher Handhabung.

The following products might also interest you:



GPN 640